

# Plat of Survey

of  
Lots 4 and 5 and the North 1/2 of  
Lot 3 of the Annex to Inlet Oaks,

a subdivision located in the Northeast 1/4 of the Northeast 1/4 of Section 22,  
Town 2 North, Range 16 East, Town of Delavan, Walworth County, Wisconsin.

Surveyed for: **Jim & Linda Spain**

3505 Emerson Street  
Franklin Park, Illinois. 60131

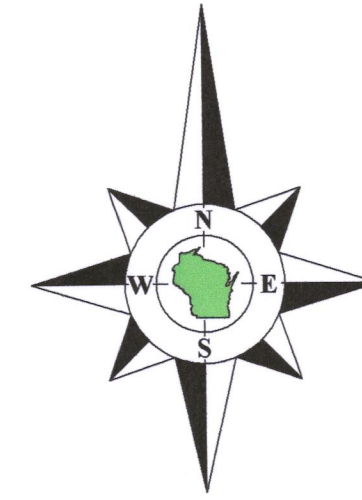

Bearings referenced to the South line of the North  
1/2 of Lot 3 of the Annex to Inlet Oaks, recorded  
as N89°28'30"W on prior surveys of record. A  
rotation of 4°09'29" from the Wisconsin State  
Plane Coordinate System, South Zone, (NAD-27).

Coordinates are referenced to the Wisconsin State  
Plane Coordinate System, South Zone, (NAD-27).

**Delavan  
Lake  
Inlet**

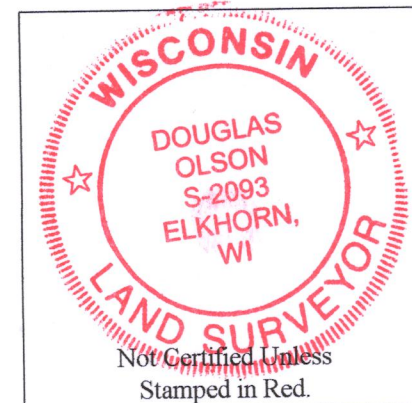

#### Notes:

- 1) This Plat of Survey is not certified unless signed and sealed in red ink.
- 2) This survey is subject to Wisconsin lien laws. This Plat of Survey is the notice of intent to file lien. Lien waiver required.
- 3) The Survey Date shown on this Plat of Survey is the completion date of the field work.

Copyright ©2019 by Olson Land Surveying, LLC.

All rights reserved. No part of this survey plat may be reproduced or transmitted in any form by any means - graphic, electronic, or mechanical, including photocopying, tracing, or information storage and retrieval systems - without permission in writing from Douglas G. Olson, Olson Land Surveying, LLC.

I hereby certify that I have surveyed the above described property in compliance with Chapter A-E 7 of the Wisconsin Administrative Code and that the map hereon is correct to the best of my professional knowledge and belief and shows the size and location of the property, its exterior boundaries, the location and dimensions of all visible structures thereon, boundary fences, apparent easements and roadways and visible encroachments, if any.

This survey is made for the exclusive use of the present owners of the property, and also those who purchase, mortgage or guarantee title thereto, within one year from the date hereof.

Douglas G. Olson  
Wisconsin Professional Land Surveyor - 2093



FIA-3 216-5582

Scale in Feet  
1" = 20'



Survey Date: March 13, 2019.  
Revisions:  
45 South Wisconsin Street P.O. Box 322  
Elkhorn, Wisconsin 53121  
Telephone: (262) 723-3434  
Facsimile: (262) 723-8044  
Email: doug@olsonsurveying.com  
Website: www.olsonsurveying.com

**OLSON**  
LAND SURVEYING, LLC  
Rural | Residential | Commercial

**Legend of Symbols & Abbreviations**  
North Arrow  
Section Corner  
Found County Pipe  
Found Iron Rod  
Found Iron Pipe  
Recorded Information  
Utility Pole  
Manhole  
Asphalt Surface  
Brick Pavers

Sheet 1 of 1 Sheets  
Drawing Name  
Job Reference Number  
**2019.021**

**2019.021**